

## Description

### Product description:

Concealed hinges are usually employed for functional or visual reasons. The hinge is mounted on the inside edge of the door and frame and is only visible when the door is open.

### Material:

Door part and frame part steel or stainless steel 1.4301 or 1.4305.

Pin steel, stainless steel 1.4301, 1.4305 or POM.

O-ring NBR.

### Version:

Door part untreated steel.

Frame part and pin electro zinc-plated steel.

Door part, frame part and pin bright stainless steel.

Pin natural tone POM.

O-ring black.

### Note:

For on-frame doors.

Hinges not visible.

Folded edge 18, 23 or 24 mm.

For right or left use.

Opening angle 120°.

Frame part for screwing on.

Form B: Door part can be welded onto the door leaf

Form C: Door part can be welded to the door edge

If mounting conditions are restricted, the POM pin can be fitted from underneath; this pin is self-locking.

### Application:

- Machine and plant construction
- Switchboxes and control housings
- Medical and laboratory technology
- Transport and conveyor systems

### Drawing reference:

- 1) Folded edge
- 2) Pin version: without slot
- 3) Pin version: with slot incl. DIN 6799 retaining washer
- 4) Pin version: with slot incl. O-ring
- 5) Pin type: self-locking
- 6) Fastening type door part: screw-on
- 7) Fastening type door part: weld-on
- 8) Notch on the door

Drawings

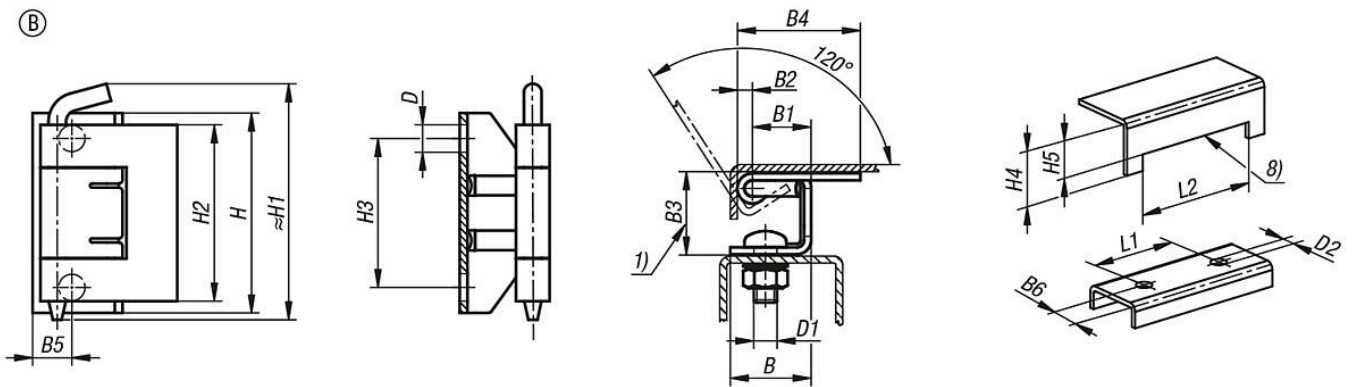

Overview of items

Order No.	Form	Door part fastening	Pin material	Pin version	Main material	B	B1	B2	B3	B4	B5	B6	D	D1	D2	H	H1	H2	H3	H4	H5	L1	L2
27878-06-0225123	B	weldable	steel	loose	steel	23	16,7	4,3	23	35	10	14	7	M6	6,5	51	60,2	45	38	23	18	38	54