

Item description/product images



Description

Material:

Stainless steel 1.4057.

Version:

Bright.

Note:

Shrink disc to connect a hollow hub to a shaft. They are mounted on the OD of the hub and generate pressure on the hub wall by reducing the ID with wedge-formed rings, creating a press fit between the hub and shaft. They are suitable for static, dynamic and shock loads.

- for extremely high torques
- no axial shaft/hub offset when assembling
- self-centring

The version 23380-01-4072 has high tensile ISO 4762 screws.

Assembly:

Remove existing transportation locks. Clean and lightly oil shaft, internal and external hub diameters. Do not use MoS₂ or grease. Slide shrink disc onto hub. Then slide unit (shrink disc/hub) onto shaft and position correctly. Gently tighten clamping screws one after the other by hand. Then use a torque wrench to tighten the clamping screws crosswise in several increments to the defined tightening torque MS.

1st increment approx. 33% MS

2nd increment approx. 66% MS

3rd increment 100% MS

Dismantling: Gradually loosen all screws one after the other but do not fully remove from the thread. The shrinking disc usually loosens itself.

Drawings

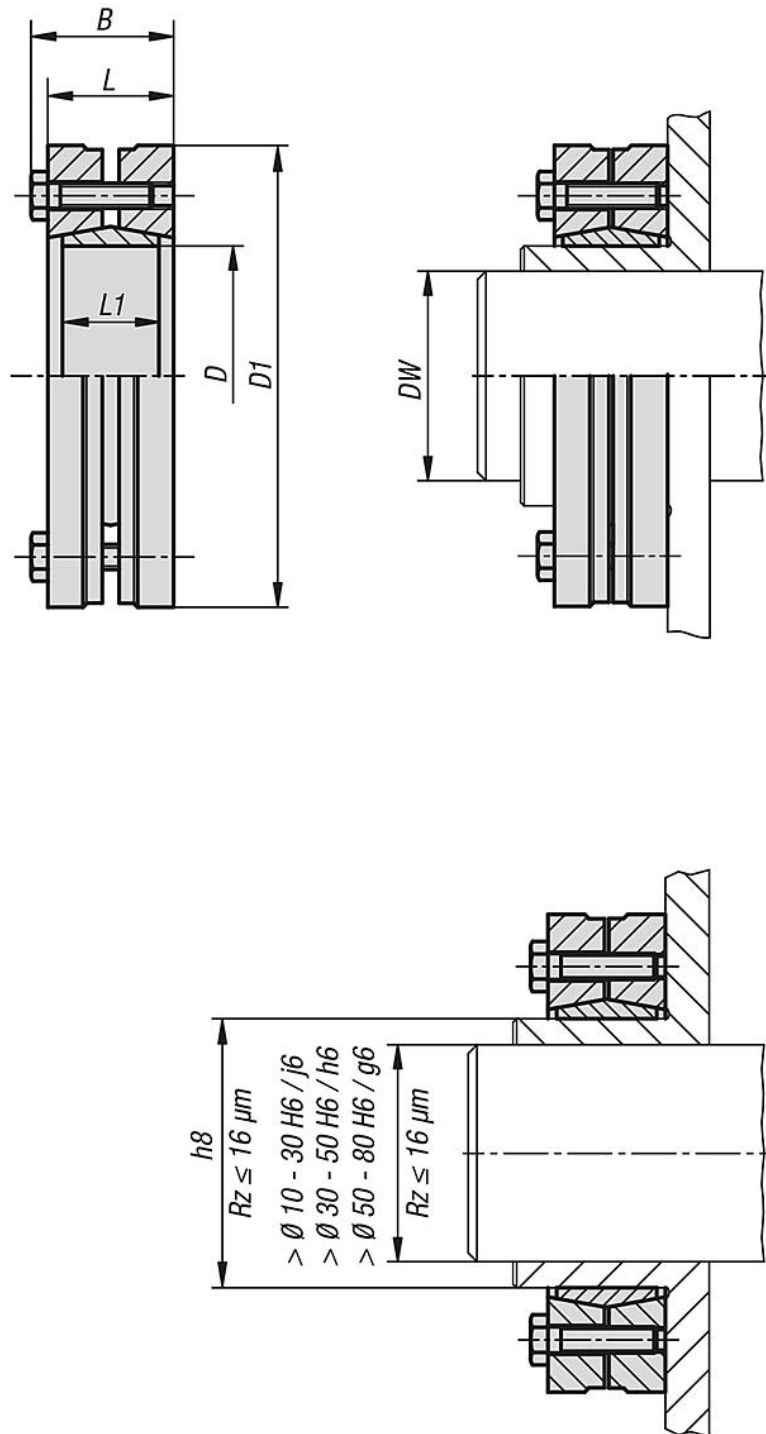

Overview of items

Order No.	Max. torque M Nm with tightening torque MS	Surface pressure on hub P N/mm ²	No. of screws	Tightening torque MS Nm
23380-01-2450	141/185/220	213	6 x M5	3
23380-01-3060	212/240/265	180	7 x M5	3
23380-01-3672	325/405/485	175	5 x M6	7
23380-01-3872	490/515/560	207	6 x M6	8,5
23380-01-4072	622/631/691	304	6 x M6	12

Overview of items

Order No.	Max. torque M Nm with tightening torque MS	Surface pressure on hub P N/mm ²	No. of screws	Tightening torque MS Nm
23380-01-4480	340/480/525	185	7 x M6	7
23380-01-4880	615/720/841	185	7 x M6	8,5
23380-01-5090	635/740/850	181	9 x M6	7
23380-01-55100	595/745/900	146	8 x M6	7
23380-01-62110	1150/1275/1450	195	12 x M6	7
23380-01-68115	905/1060/1450	145	10 x M6	7
23380-01-75138	995/1310/1725	140	7 x M8	15
23380-01-80145	1150/1275/1450	132	7 x M8	15

Order No.	D	D1	DW	B	L	L1
23380-01-2450	24	50	19/20/21	25	21	15
23380-01-3060	30	60	24/25/26	27	23	18
23380-01-3672	36	72	28/30/31	29	25	19
23380-01-3872	38	72	29/30/31	31	27	21
23380-01-4072	40	72	30/31/32	31	27	21
23380-01-4480	44	80	32/35/36	30	28	22
23380-01-4880	48	80	36/38/40	33	30	22
23380-01-5090	50	90	38/40/42	34	30	22
23380-01-55100	55	100	42/45/48	35	31	23
23380-01-62110	62	110	48/50/52	36	32	23
23380-01-68115	68	115	50/55/60	37	33	23
23380-01-75138	75	138	55/60/65	39	33	25
23380-01-80145	80	145	60/65/70	39	33	25