

Item description/product images



Description

Material:

Housing, steel.
Magnetic core, SmCo.

Version:

Housing, electro zinc-plated.

Note:

Shallow pot magnets, shielded system. Magnets with an SmCo core have three to five times the attracting force of AlNiCo or hard ferrite magnets.

Temperature range:

max. 200°C.

Drawing reference:

1) magnetic face

Drawings

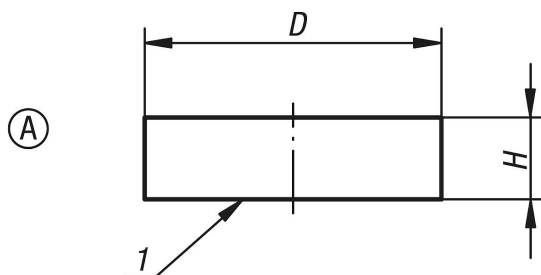

Overview of items

Order No.	Form	D	H	Magnetic force N
09066-01	A	6 ±0,15	4,5	5
09066-02	A	8 ±0,15	4,5	11
09066-03	A	10 ±0,15	4,5	20
09066-04	A	13 ±0,15	4,5	40
09066-05	A	16 ±0,15	4,5	60
09066-06	A	20 ±0,15	6	90
09066-07	A	25 ±0,15	7	150
09066-08	A	32 ±0,20	7	220