

## Item description/product images



## Description

**Material:**

Knobs thermoset PF 31.

Rod steel 1.0718 or stainless steel 1.4305.

**Version:**

Thermoset black, high-gloss polished.

Steel black oxidised or bright stainless steel.

## Drawings

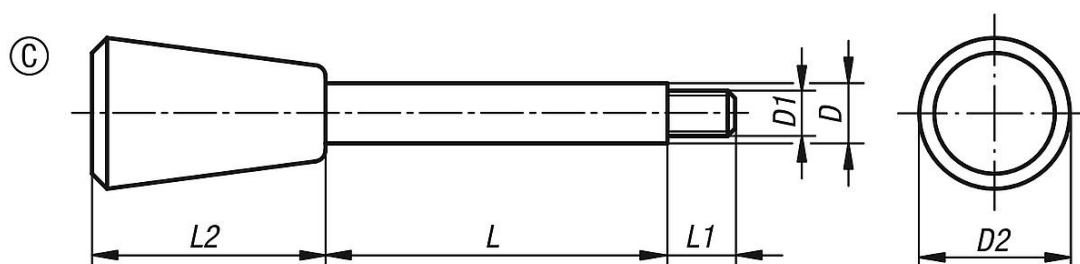

## Overview of items

Order No.	Main material	Form	D	D1	D2	L	L1	L2
06360-408X35	steel	C	8	M6	20	35	9	31
06360-408X50	steel	C	8	M6	20	50	9	31
06360-408X65	steel	C	8	M6	20	65	9	31
06360-410X50	steel	C	10	M8	25	50	13	38
06360-410X65	steel	C	10	M8	25	65	13	38
06360-410X80	steel	C	10	M8	25	80	13	38
06360-410X100	steel	C	10	M8	25	100	13	38
06360-412X65	steel	C	12	M10	30	65	15	46
06360-412X80	steel	C	12	M10	30	80	15	46
06360-412X100	steel	C	12	M10	30	100	15	46
06360-412X125	steel	C	12	M10	30	125	15	46
06360-414X80	steel	C	14	M12	35	80	16	53
06360-414X100	steel	C	14	M12	35	100	16	53
06360-414X125	steel	C	14	M12	35	125	16	53
06360-414X160	steel	C	14	M12	35	160	16	53
06360-1408X35	stainless steel	C	8	M6	20	35	9	31
06360-1408X50	stainless steel	C	8	M6	20	50	9	31
06360-1408X65	stainless steel	C	8	M6	20	65	9	31
06360-1410X50	stainless steel	C	10	M8	25	50	13	38
06360-1410X65	stainless steel	C	10	M8	25	65	13	38
06360-1410X80	stainless steel	C	10	M8	25	80	13	38
06360-1410X100	stainless steel	C	10	M8	25	100	13	38
06360-1412X65	stainless steel	C	12	M10	30	65	15	46
06360-1412X80	stainless steel	C	12	M10	30	80	15	46
06360-1412X100	stainless steel	C	12	M10	30	100	15	46
06360-1412X125	stainless steel	C	12	M10	30	125	15	46
06360-1414X80	stainless steel	C	14	M12	35	80	16	53
06360-1414X100	stainless steel	C	14	M12	35	100	16	53
06360-1414X125	stainless steel	C	14	M12	35	125	16	53
06360-1414X160	stainless steel	C	14	M12	35	160	16	53

