

Item description/product images



Description

Material:

Body high carbon steel.

Version:

Body tempered and black oxidised.

Contact faces case-hardened.

Note:

These positioning feet are used as supports for rough and machined parts. They can also be used as stops and thrust pads in fixtures and toolmaking.

Drawings

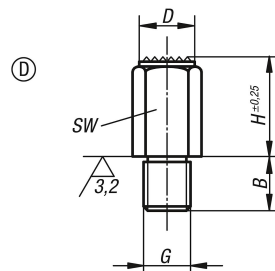

Overview of items

Order No.	Form	B	D	G	H	SW
02041-406010	D	11	10	M6	10	10
02041-406020	D	11	10	M6	20	10
02041-408015	D	13	13	M8	15	13
02041-408030	D	13	13	M8	30	13
02041-410020	D	16	17	M10	20	17
02041-410040	D	16	17	M10	40	17
02041-412025	D	20	19	M12	25	19
02041-412050	D	20	19	M12	50	19
02041-416030	D	24	27	M16	30	27
02041-416060	D	24	27	M16	60	27
02041-420040	D	29	32	M20	40	32
02041-420080	D	29	32	M20	80	32

Overview of items
