

Item description/product images



Description

Material:

Carbon steel 1.1191

Version:

Tempered to 8.8 and black oxidised.

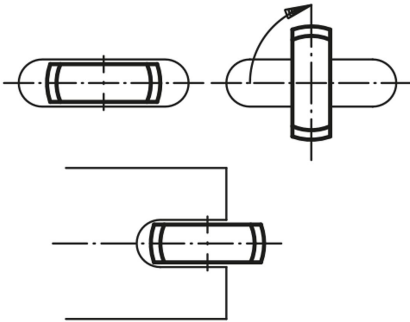

Drawings

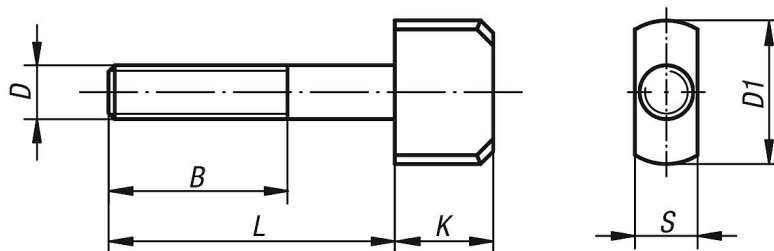

Overview of items

Order No.	B	D	D1	K	L	S
07570-06	25	M6	20	14	30	6,5
07570-08	30	M8	25	16	40	8,5
07570-10	40	M10	28	16	50	10,5
07570-12	50	M12	32	20	60	12,5

