

Item description/product images



Description

Material:
Steel 1.0503 (C45).

Version:
Milled tothing, straight teeth.
Engagement angle 20°, bright.
Axis angle = 90°.

Note for ordering:
Bevel gears are supplied singly. To obtain a pair of bevel gears, please order the specified mating gear as well.

Drawings

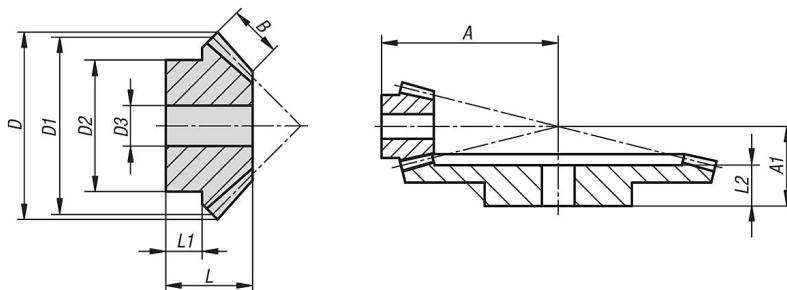

Overview of items

Order No.	Transmission ratio	Module	No. of teeth	A	A1	B	D	D1	D2	D3	L	L1	L2	matching opposing gear
22430-010140015	1:4	1	15	38	-	9,3	17,8	15	13,3	4	17,2	7,7	-	22430-010140060
22430-010140060	1:4	1	60	-	22	9,3	60,3	60	30,3	8	17,1	10	15	22430-010140015
22430-015140015	1:4	1,5	15	57	-	11	26,7	22,5	20,3	8	23	11,7	-	22430-015140060
22430-015140060	1:4	1,5	60	-	42	11	90,4	90	50,3	15	34	25	31	22430-015140015
22430-020140015	1:4	2	15	75	-	16	35,6	30	25,3	8	31	14,4	-	22430-020140060
22430-020140060	1:4	2	60	-	48	16	120,6	120	60,3	16	37,6	25	34	22430-020140015
22430-025140015	1:4	2,5	15	94	-	19	44,5	37,5	32,3	14	38,1	18,4	-	22430-025140060
22430-025140060	1:4	2,5	60	-	58	19	150,7	150	60,3	20	44,8	30	40	22430-025140015
22430-030140015	1:4	3	15	115	-	23	53,3	45	40,3	15	48,1	24,5	-	22430-030140060
22430-030140060	1:4	3	60	-	69	23	180,8	180	80,3	20	53,2	35	48	22430-030140015