

## Item description/product images



## Description

**Material:**  
Stainless steel A2.

**Version:**  
Bright.

**Note:**  
These stainless steel mounting brackets are used to mount the LED machine lamps 86025.

They permit the LED lamps to be infinitely rotated through 110° and secured.

The two brackets are screwed into the tapped holes on the end caps of the lamp using M4x8 supplied.

**Supplied with:**  
2x mounting brackets.  
4x DIN EN ISO 7380 M4x8 screws with flattened pan heads.

## Drawings

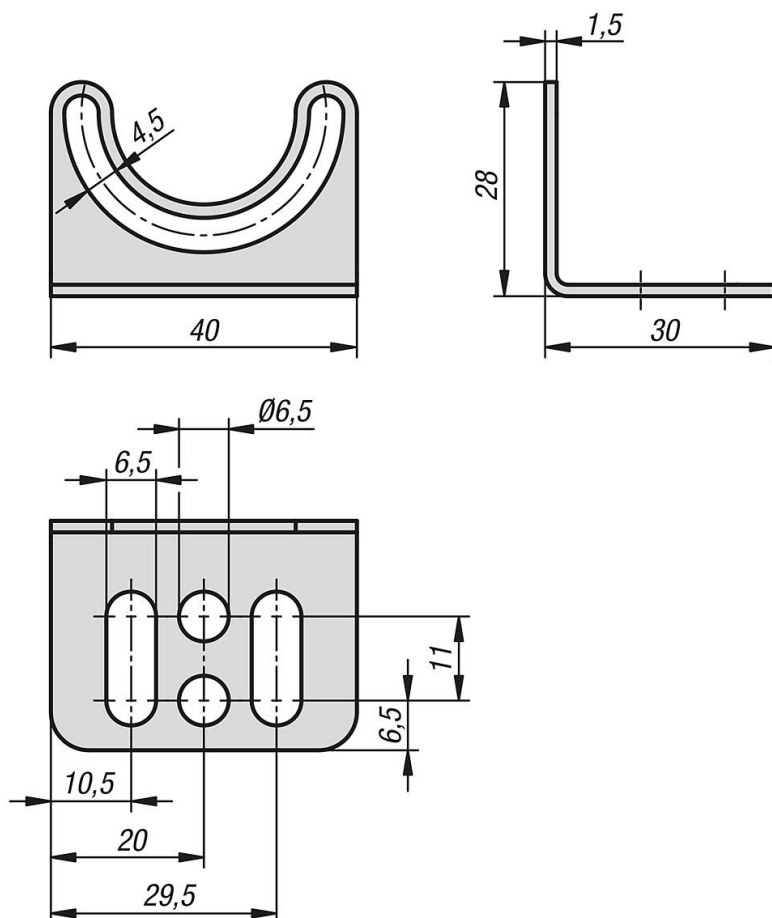

## Overview of items

Order No.	Item
86090-20-302840	Catch plate