

Item description/product images



Description

Material:

Housing steel.
Magnetic core NdFeB (neodymium).
Rubber protective jacket TPE.

Version:

Housing, electro zinc-plated.
Black protective rubber jacket.

Note:

Magnet with internal thread. Shielded system. With rubber protective jacket for protecting sensitive surfaces. The coefficient of friction is increased by the rubber jacket so that high lateral friction is achieved.

Temperature range:

max. 60°C.

Assembly:

Optimum hold on thin plate with sensitive surfaces.

Drawing reference:

1) magnetic face

Drawings

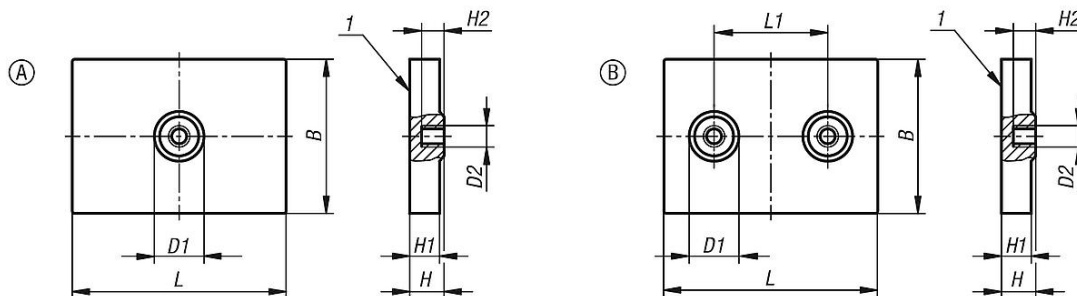

Overview of items

Order No.	Form	B	D1	D2	H	H1	H2	L	L1	Magnetic force N
09112-10-14331	A	31	10	M4	6,9	6	4,5	43	-	105
09112-10-24331	B	31	10	M4	6,9	6	4,5	43	25	146