

Item description/product images



Description

Material:

Washers low carbon steel 1.7139.

Version:

case-hardened.

Note:

The washers for countersunk screws are components that can be used in tool and die making. They can be used to optimise the connection between countersunk screws and the workpiece by providing stability, alignment and fastening strength.

Drawings

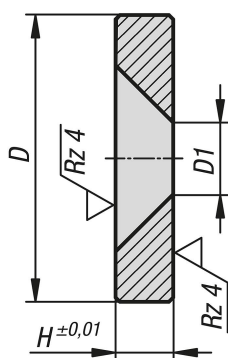

Overview of items

Order No.	D	D1	H
07375-10-18	18	4,5	3
07375-10-20	20	5,4	4
07375-10-28	28	5,2	3
07375-10-30	30	5,4	4