

## Item description/product images



## Description

**Material:**

Wheel rim die-cast aluminium.  
Tread Extrathane®.

**Note:**

These wheels are elastic, abrasion-resistant, gentle to floors, low-noise and have low roll resistance.

Suitable as replacement rollers for castors 95028.

## Drawings

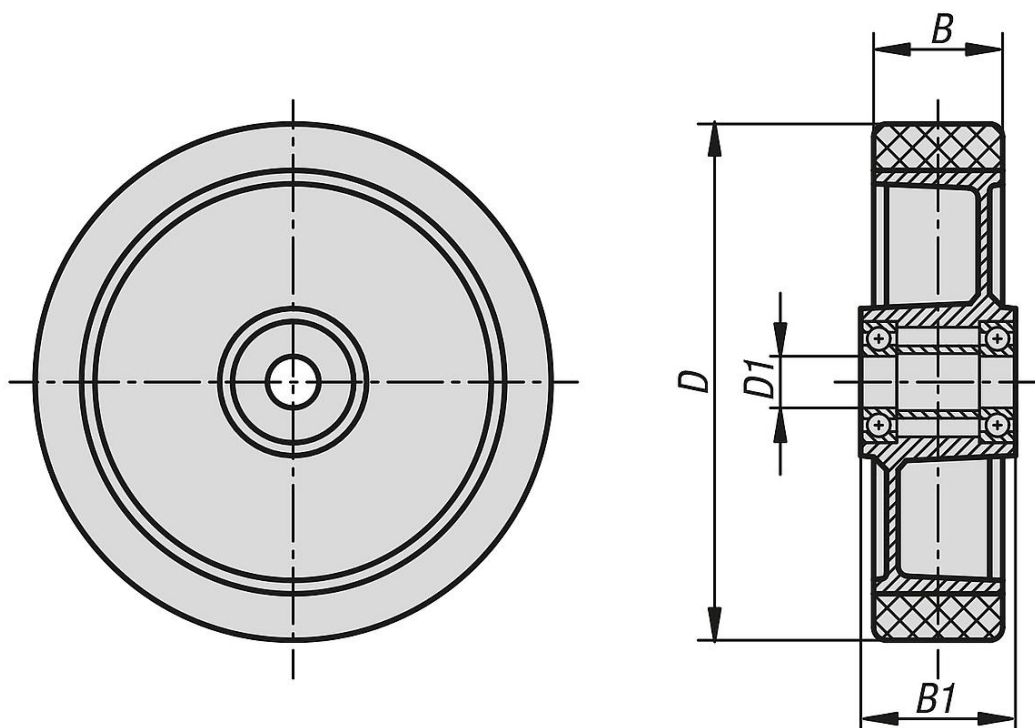

## Overview of items

Order No.	Wheel bearing	D	D1	B	B1	Permissible load kg
95058-10040	Ball bearing	100	15	40	45	250
95058-12540	Ball bearing	125	15	40	45	350
95058-16050	Ball bearing	160	20	50	60	550
95058-18050	Ball bearing	180	20	50	60	600
95058-20050	Ball bearing	200	20	50	60	800

