

## Item description/product images



## Description

**Material:**

Polyamide fibreglass reinforced.

**Version:**

black.

**Note:**

The cable tie block is a fastening component for cables and hoses. Can be mounted on panel elements or aluminium profiles (5 to 12 mm slots) with a cap screw or pan head screw and a slot key.

The cables and hoses are held in place using cable ties.



## Drawings

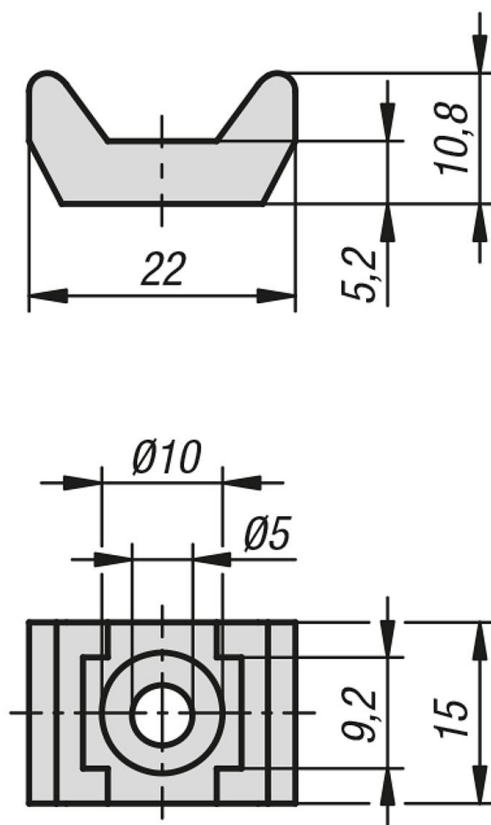

## Overview of items

Order No.	Slot width
10451-01	5-12

