

Item description/product images



Description

Material:
Steel.

Version:
Bright, grade 10.9

Drawings

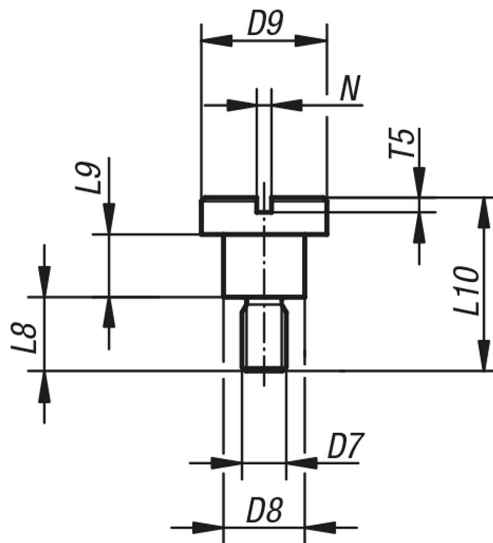

Overview of items

Order No.	Product type	D7	for drill bushes (D1)	L8	L9	L10	D8	D9	N	T5
08927-05X03	short	M5	≤6,0	9	3	15	7,5	13	1,6	2
08927-06X04	short	M6	> 6,0 ≤ 12,0	10	4	18	9,5	16	2	2,5
08927-08X55	short	M8	> 12,0 ≤ 30,0	11,5	5,5	22	12	20	2,5	3
08927-05X06	long	M5	≤6,0	9	6	18	7,5	13	1,6	2
08927-06X08	long	M6	> 6,0 ≤ 12,0	10	8	22	9,5	16	2	2,5
08927-08X105	long	M8	> 12,0 ≤ 30,0	11,5	10,5	27	12	20	2,5	3

Overview of items

Information about this article

DIN 173 flat head screws for replaceable drill bushes The steel flat head screws are used with DIN 173 replaceable drill bushes with a diameter of up to 30 mm. If flat head screws are required for an application, these from norelem will meet all requirements. Our screws are grade 10.9. They are available in the sizes M5 to M8 making them ideal for mounting drill bushes. The drill bushes can only be correctly mounted with no annoying protruding edges when the correct size of flat head screw is used.