

## Item description/product images



## Description

**Material:**

Polyamide (PA6).  
Brass.  
Stainless steel 1.4301.

**Version:**

Plastic light grey RAL 7035.  
Brass nickel-plated.  
Stainless steel bright.

**Note:**

DIN EN 60423 hex nuts with metric thread. For securing cable glands and accessories.

**Temperature range:**

-40 °C to +100 °C (plastic).  
-60 °C to +200 °C (metal).

## Drawings

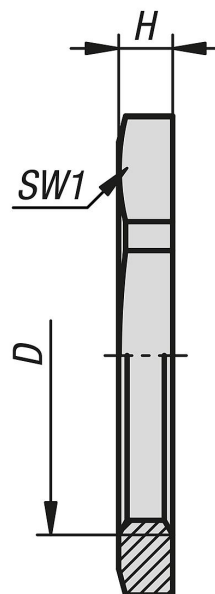

## Overview of items

Order No.	Main material	D	H	SW1	Max. tightening torque on SW1 Nm
84100-30-012150	polyamide	M12X1,5	5	17	1,5
84100-30-016150	polyamide	M16x1,5	5	22	2,5
84100-30-020150	polyamide	M20X1,5	6	27	3,5
84100-30-025150	polyamide	M25x1,5	6	32	5
84100-30-032150	polyamide	M32x1,5	7	41	5
84100-30-040150	polyamide	M40X1,5	7	50	7,5
84100-30-11215	brass	M12X1,5	2,8	15	3,5
84100-30-11615	brass	M16x1,5	2,8	19	3,5
84100-30-12015	brass	M20X1,5	3	24	3,5
84100-30-12515	brass	M25x1,5	3,5	30	6,7

## Overview of items

Order No.	Main material	D	H	SW1	Max. tightening torque on SW1 Nm
84100-30-13215	brass	M32x1,5	4	36	12
84100-30-14015	brass	M40x1,5	5	46	13,5
84100-30-21215	stainless steel	M12x1,5	2,8	14	3,5
84100-30-21615	stainless steel	M16x1,5	2,8	19	3,5
84100-30-22015	stainless steel	M20x1,5	3	24	3,5
84100-30-22515	stainless steel	M25x1,5	3,5	30	6,7
84100-30-23215	stainless steel	M32x1,5	4	36	12
84100-30-24015	stainless steel	M40x1,5	5	46	13,5