

Item description/product images



Description

Material:

DIN EN 10305 precision tube, stainless steel 1.4301
Trapezoidal thread spindle, right-hand thread, rolled, stainless steel 1.4301

Note:

Medium speed range, self-locking.

Travel $S = \text{Length } L - (2 \times L2 + J)$.

On request:

Left-hand thread, 2 drive cones, other travels or handwheels.

Accessory:

- Guides, stainless steel, 29120, 29130, 29135
- Clamping elements of the tubular connection system

Functional principle:

A rotating movement of the threaded spindle is converted into a linear movement of the guide carriage.

Drawings

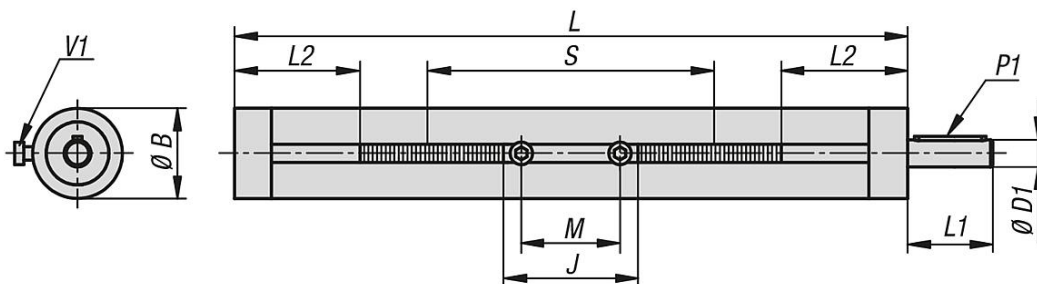

Overview of items

| Order No. | Version 1 | Type E | Spindle | L | Travel S | B | D1 | J | L1 | L2 | M | P1 parallel key DIN 6885 | V1 |
|--------------------|-------------------|--------|---------|------|----------|----|-------|----|----|----|----|--------------------------|-------|
| 29105-1300101X300 | with ball bearing | 30 | Tr 14x3 | 300 | 109 | 30 | 8 h8 | 31 | 26 | 80 | 22 | 2 x 2 x 20 | M4x8 |
| 29105-1300101X500 | with ball bearing | 30 | Tr 14x3 | 500 | 309 | 30 | 8 h8 | 31 | 26 | 80 | 22 | 2 x 2 x 20 | M4x8 |
| 29105-1300101X800 | with ball bearing | 30 | Tr 14x3 | 800 | 609 | 30 | 8 h8 | 31 | 26 | 80 | 22 | 2 x 2 x 20 | M4x8 |
| 29105-1400101X300 | with ball bearing | 40 | Tr 20x4 | 300 | 107 | 40 | 12 h8 | 39 | 38 | 77 | 28 | 4 x 4 x 32 | M6x10 |
| 29105-1400101X500 | with ball bearing | 40 | Tr 20x4 | 500 | 307 | 40 | 12 h8 | 39 | 38 | 77 | 28 | 4 x 4 x 32 | M6x10 |
| 29105-1400101X800 | with ball bearing | 40 | Tr 20x4 | 800 | 607 | 40 | 12 h8 | 39 | 38 | 77 | 28 | 4 x 4 x 32 | M6x10 |
| 29105-1400101X1000 | with ball bearing | 40 | Tr 20x4 | 1000 | 807 | 40 | 12 h8 | 39 | 38 | 77 | 28 | 4 x 4 x 32 | M6x10 |