

Item description/product images



Description

Material:

Sleeve 1.4305.
Thrust pin 1.4034.
Spring 1.4310.

Version:

Bright.
Thrust pin hardened.

Drawings

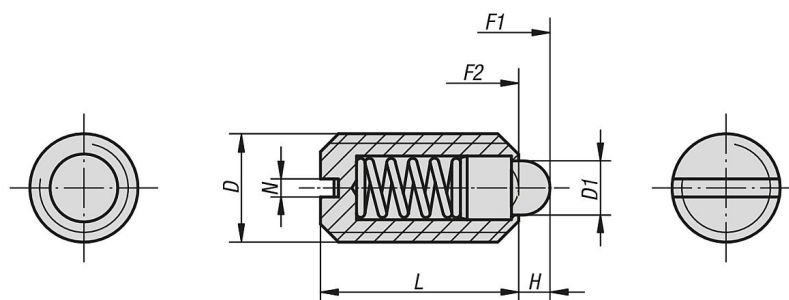

Overview of items

Spring plungers with slot and thrust pin, standard spring force

Order No.	Main material	D	D1	H	L	N	Spring force initial pressure F1 approx. N	Spring force final pressure F2 approx. N
03025-04	stainless steel	M4	1,8	1,5	9	0,6	6	20
03025-05	stainless steel	M5	2,4	2	12	0,8	6	20
03025-06	stainless steel	M6	2,7	2	14	1	7	20
03025-08	stainless steel	M8	4	2	16	1,2	15	30
03025-10	stainless steel	M10	4,5	2,5	19	1,6	20	35
03025-12	stainless steel	M12	6	3,5	22	2	30	55
03025-16	stainless steel	M16	8,5	4,5	24	2,5	45	100
03025-20	stainless steel	M20	10	6,5	30	2,5	60	120
03025-104	stainless steel	M4	1,8	1,5	9	0,6	3	10
03025-105	stainless steel	M5	2,4	2	12	0,8	3	10
03025-106	stainless steel	M6	2,7	2	14	1	4	10
03025-108	stainless steel	M8	4	2	16	1,2	7	15
03025-110	stainless steel	M10	4,5	2,5	19	1,6	9	16
03025-112	stainless steel	M12	6	3,5	22	2	14	26
03025-116	stainless steel	M16	8,5	4,5	24	2,5	22	50
03025-120	stainless steel	M20	10	6,5	30	2,5	30	60
03025-205	stainless steel	M5	2,4	2	12	0,8	9	25
03025-206	stainless steel	M6	2,7	2	14	1	11	25
03025-208	stainless steel	M8	4	2	16	1,2	22	43
03025-210	stainless steel	M10	4,5	2,5	19	1,6	20	54
03025-212	stainless steel	M12	6	3,5	22	2	36	94
03025-216	stainless steel	M16	8,5	4,5	24	2,5	60	110

