

Item description/product images



Description

Material:

Housing, steel.
Magnetic core NdFeB.

Version:

Housing, electro zinc-plated.

Note:

Shielded system. With the permanent magnetic material NdFeB the attractive force increases by ca. 10-20 % compared with SmCo.

Temperature range:

max. 80°C.

Drawing reference:

1) magnetic face

Drawings

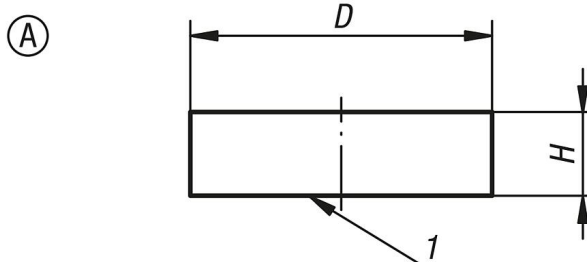

Overview of items

Order No.	Form	D	H	Magnetic force N
09069-01	A	6 ±0,15	4,5	5
09069-02	A	8 ±0,15	4,5	13
09069-03	A	10 ±0,15	4,5	25
09069-04	A	13 ±0,15	4,5	60
09069-05	A	16 ±0,15	4,5	95
09069-06	A	20 ±0,15	6	140
09069-07	A	25 ±0,15	7	200
09069-08	A	32 ±0,20	7	350