

Item description/product images



Description

Material:

Steel or 1.4305 stainless steel.

Version:

Steel trivalent blue passivated.

Stainless steel, bright.

Note:

Levelling feet consist of a plate and a threaded spindle. Any plate can be combined with any threaded spindle.

The height of the complete levelling foot is calculated from the length of the threaded spindle + 30 mm.

(Total height of levelling foot = L + 30 mm)

Drawings

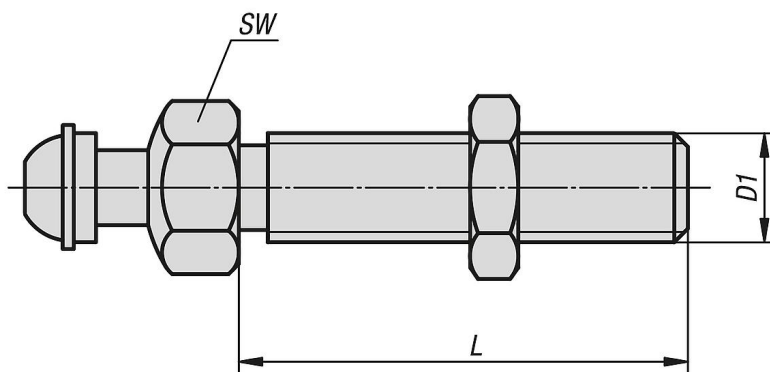

Overview of items

Order No.	Main material	D1	L	SW	Load rating max. kN
27828-120661	steel	M12	66	22	7,7
27828-121001	steel	M12	100	22	7,7
27828-121251	steel	M12	125	22	7,7
27828-121501	steel	M12	150	22	7,7
27828-160661	steel	M16	66	22	14,5
27828-161001	steel	M16	100	22	14,5
27828-161251	steel	M16	125	22	14,5
27828-161501	steel	M16	150	22	14,5
27828-162001	steel	M16	200	22	14,5
27828-201001	steel	M20	100	22	24,3
27828-201251	steel	M20	125	22	24,3
27828-201501	steel	M20	150	22	24,3
27828-202001	steel	M20	200	22	24,3
27828-120662	stainless steel	M12	66	22	7,7
27828-121002	stainless steel	M12	100	22	7,7
27828-121252	stainless steel	M12	125	22	7,7
27828-121502	stainless steel	M12	150	22	7,7
27828-160662	stainless steel	M16	66	22	14,5
27828-161002	stainless steel	M16	100	22	14,5
27828-161252	stainless steel	M16	125	22	14,5
27828-161502	stainless steel	M16	150	22	14,5
27828-162002	stainless steel	M16	200	22	14,5
27828-201002	stainless steel	M20	100	22	24,3
27828-201252	stainless steel	M20	125	22	24,3

Overview of items

Order No.	Main material	D1	L	SW	Load rating max. kN
27828-201502	stainless steel	M20	150	22	24,3
27828-202002	stainless steel	M20	200	22	24,3