



## Description

### Material:

Steel version:

Indexing pin hardened:

Threaded sleeve and indexing pin free-cutting steel

Stainless steel version:

Indexing pin hardened:

Threaded sleeve 1.4305

Indexing pin 1.4034.

Mushroom knob black grey thermoplastic.

Thread lock blue polyamide.

### Version:

Steel version:

indexing pin hardened, ground and black oxidised.

Stainless steel version:

indexing pin hardened, ground and bright.

### Note:

Indexing plungers are used to prevent any change in locking position due to lateral forces. A new locking position can only be set after the pin has been manually disengaged. Form CP is recommended for applications where the plunger remains disengaged over a long period and the pin should be prevented from springing back. The thread lock enables the plunger to be screwed in to the exact depth required, no spacer ring is required.

The thread lock is a gripping polyamide coating that is applied punctiform (spot).

### On request:

Special versions.

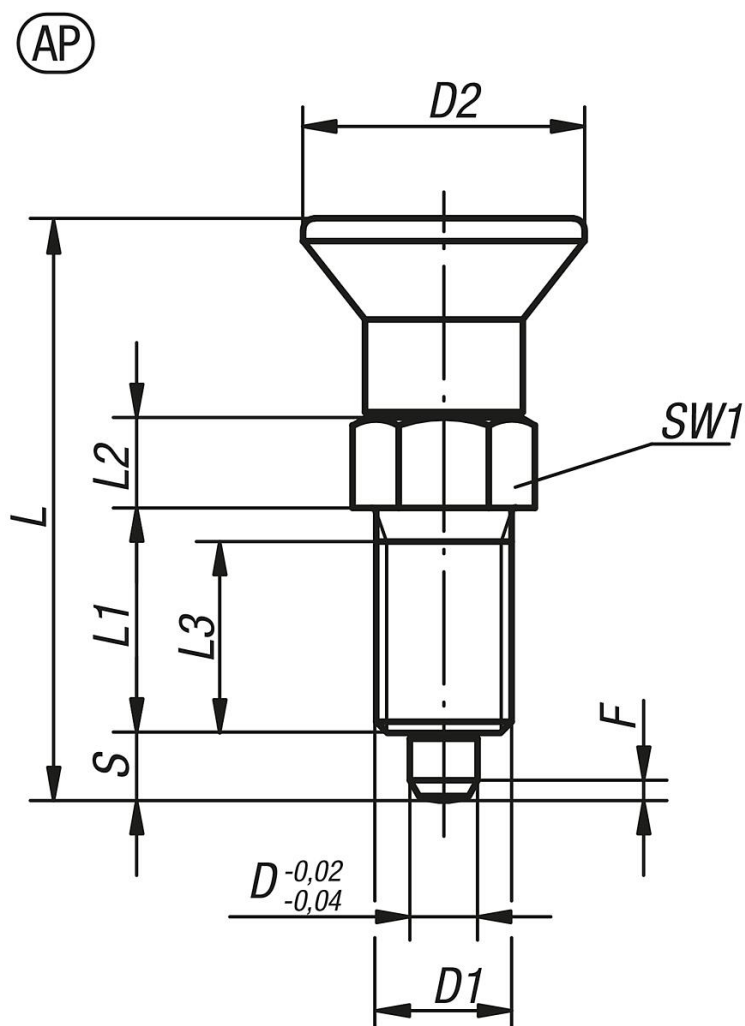

Overview of items

Order No. steel	Order No. stainless steel	Form	D	D1	D2	L	L1	L2	L3	Travel S	SW1	Fx30°	Spring force initial pressure F1 approx. N	Spring force final pressure F2 approx. N
03089-91903	03089-091903	AP	3	M6x0,75	14	31,5	12	5	10	3,5	8	0,8	4,5	10
03089-91004	03089-091004	AP	4	M8x1	18	38,5	15	6	13	4	10	1	6	12
03089-91105	03089-091105	AP	5	M10x1	21	43,5	17	7	15	5	13	1,3	5	12
03089-91206	03089-091206	AP	6	M12x1,5	25	51,7	20	8	17	6	14	1,8	6	14
03089-91308	03089-091308	AP	8	M16x1,5	33	68	26	10	23	8	19	2,3	15	35
03089-91410	03089-091410	AP	10	M20x1,5	33	74	28	12	25	10	22	2,8	15	34
03089-91412	03089-091412	AP	12	M20x1,5	33	78	28	14	25	12	22	2,8	15	39
03089-91516	03089-091516	AP	16	M24x2	40	96	32	18	28	16	27	3,2	20	46