

Item description/product images



Description

Material:

Metal parts, steel, grade 5.6.

Elastomer natural rubber, medium hardness, Shore 57A.

Version:

Steel electro zinc-plated.

Note:

The rubber buffers are widely-used construction elements for elastic mounting. They are used, among other things, as mountings for aggregates, motors, compressors, pumps and testing machinery.

Rubber buffers with a waisted contour reduce high edge loads on the rubber by radial deflection and so increase the components service life.

Due to the material composition, rubber buffers are contact-colouring, which can lead to abrasion marks and discolouration on e.g. floors or contact surfaces.

Rubber buffers made of light grey EPDM that are not contact-colouring are available on request.

Temperature range:

-30 °C to +80 °C

On request:

Other Shore grades.

Drawings

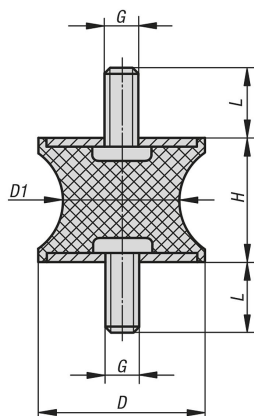

Overview of items

Order No.	D	D1	H	G	L	Spring stiffness N/mm	Load N
26101-01001057	10	8	10	M4	13	31	37
26101-01501557	15	12	15	M4	13	71	135
26101-02001557	20	14	15	M6	18	177	283
26101-03002057	30	22	20	M8	23	212	763
26101-04003057	40	33	30	M8	23	202	1111
26101-04004857	40	20	48	M8	23	101	626
26101-05003057	50	40	30	M10	28	351	1229
26101-07504057	75	50	40	M12	37	466	2330

Overview of items
