

Item description/product images



Description

Material:

Metal parts steel grade 5.6 or stainless steel.
Elastomer natural rubber, medium hardness, Shore 55A.

Version:

Steel electro zinc-plated.
Stainless steel bright.

Note:

The rubber buffers are widely-used construction elements for elastic mounting. They are used, among other things, as mountings for aggregates, motors, compressors, pumps and testing machinery.

Due to the material composition, rubber buffers are contact-colouring, which can lead to abrasion marks and discolouration on e.g. floors or contact surfaces.

Rubber buffers made of light grey EPDM that are not contact-colouring are available on request.

Temperature range:

-30 °C to +80 °C

On request:

Other Shore grades.

Drawings

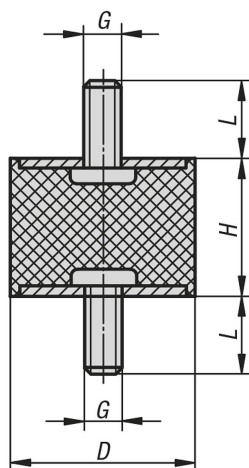

Overview of items

Order No.	Main material	D	G	L	H	Spring stiffness N/mm	Load N
26100-00800855	steel	8	M3	6	8	24	31
26100-01001055	steel	10	M4	10	10	35	32
26100-01001555	steel	10	M4	10	15	50	50
26100-01500855	steel	15	M4	10	8	130	104
26100-01501055	steel	15	M4	10	10	122	122
26100-01501555	steel	15	M4	10	15	59	88
26100-02000855	steel	20	M6	18	8	725	580
26100-02001055	steel	20	M6	18	10	300	300

26100 Rubber buffers steel or stainless steel, type A cylindrical with external thread both sides



Overview of items

Order No.	Main material	D	G	L	H	Spring stiffness N/mm	Load N
26100-02001555	steel	20	M6	18	15	200	300
26100-02002055	steel	20	M6	18	20	133	332
26100-02002555	steel	20	M6	18	25	90	270
26100-02501055	steel	25	M6	18	10	800	800
26100-02501555	steel	25	M6	18	15	294	441
26100-02502055	steel	25	M6	18	20	200	500
26100-02502555	steel	25	M6	18	25	94	282
26100-02503055	steel	25	M6	18	30	70	280
26100-03001555	steel	30	M8	23	15	587	880
26100-03002055	steel	30	M8	23	20	318	795
26100-03002555	steel	30	M8	23	25	183	549
26100-03003055	steel	30	M8	23	30	150	600
26100-03004055	steel	30	M8	23	40	77	385
26100-04001555	steel	40	M8	23	15	1250	1875
26100-04002055	steel	40	M8	23	20	565	1412
26100-04003055	steel	40	M8	23	30	300	1200
26100-04004055	steel	40	M8	23	40	189	945
26100-05002055	steel	50	M10	28	20	1300	3250
26100-05002555	steel	50	M10	28	25	667	2000
26100-05003055	steel	50	M10	28	30	500	2000
26100-05004055	steel	50	M10	28	40	300	1500
26100-05005055	steel	50	M10	28	50	193	1153
26100-06004055	steel	60	M10	28	40	377	1885
26100-07004555	steel	70	M10	28	45	410	2255
26100-07502555	steel	75	M12	37	25	1655	4965
26100-07504055	steel	75	M12	37	40	717	3585
26100-07505055	steel	75	M12	37	50	470	2820
26100-07505555	steel	75	M12	37	55	405	2835
26100-015015551	stainless steel	15	M4	12	15	59	88
26100-020015551	stainless steel	20	M6	18	15	200	300
26100-025020551	stainless steel	25	M6	18	20	200	500
26100-030020551	stainless steel	30	M8	23	20	318	795
26100-030025551	stainless steel	30	M8	23	25	183	549
26100-040030551	stainless steel	40	M8	23	30	300	1200