

## Item description/product images



## Description

**Material:**

Housing and clamping arm steel.

**Note:**

Manual clamp with integrated toggle lever mechanism for over dead centre locking.

The clamping arm is has a fixed stop for reproducible end positions.

The housing features a hole pattern at the front.

All hinge pins for the mechanics are in bushes.

The hand lever has an ergonomic ball grip.

The clamping arm has a hole pattern for mounting thrust pads.

## Drawings

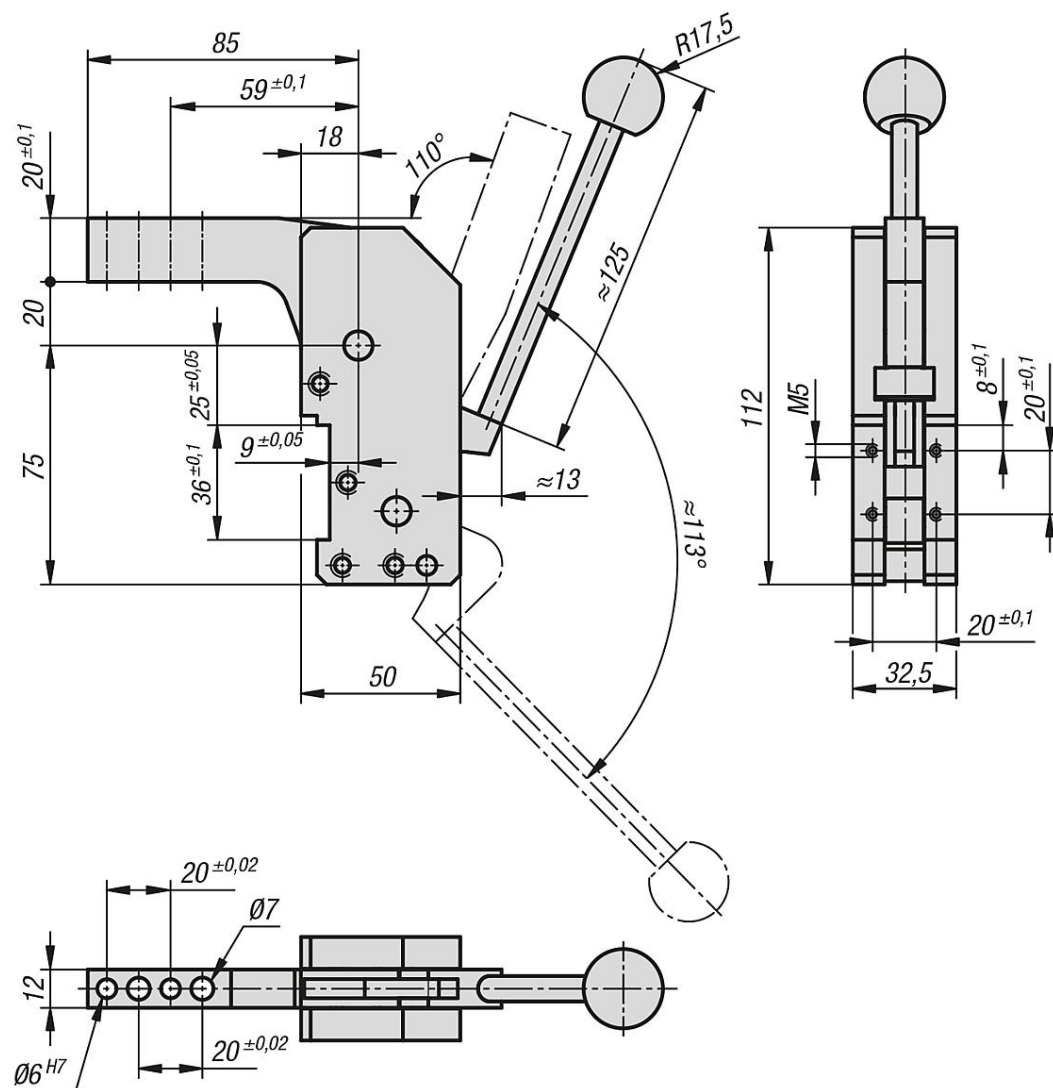

## Overview of items

Order No.	Clamping torque Mx Nm	Retaining torque Nm
05666-55	55	110