

Item description/product images

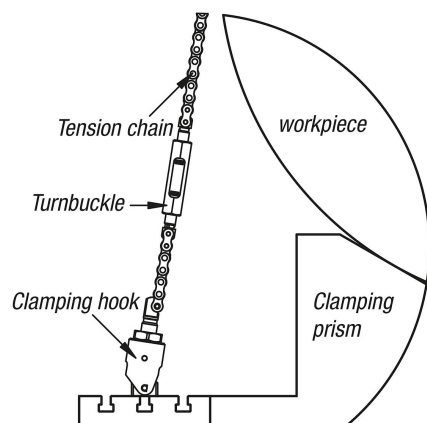

Description

Material:

Steel.

Note:

Steel turnbuckles for chain clamp sets are mounted between the chains. The turnbuckles are used to pre-tension the chain and remove any play, which is always greater with longer chains.

Accessory:

Steel roller chains for chain clamp sets 04211-03.

Drawings

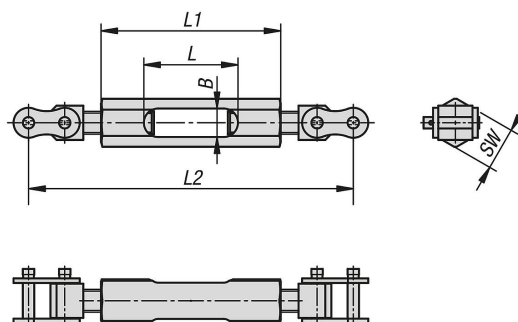

Overview of items

Order No.	B	L	L1	L2	SW	Clamping force max. kN
04211-06-15052	14	52	97	143-178	24	15
04211-06-40066	20	66	126	202-253	30	40
04211-06-75092	31	92	180	270-333	50	75
04211-06-120092	31	92	180	291-360	50	120