

Item description/product images

**Description****Material:**

Die cast aluminium.
End caps plastic.

Version:

Black powder-coated.
End caps black.

Note:

For the simple and safe locking of doors and hatches. Installed from the front without mechanical processing using M6 cylinder-head or cheese-head screws. Secured to prevent removal when locked.

The key-operated version is supplied with 2 keys. The key can be removed in both positions (open and closed). The locks are keyed alike, i.e. they can all be opened using the same key (euro key 5333).

Drawing reference:

Actuation:

a) Key single-key system



Drawings

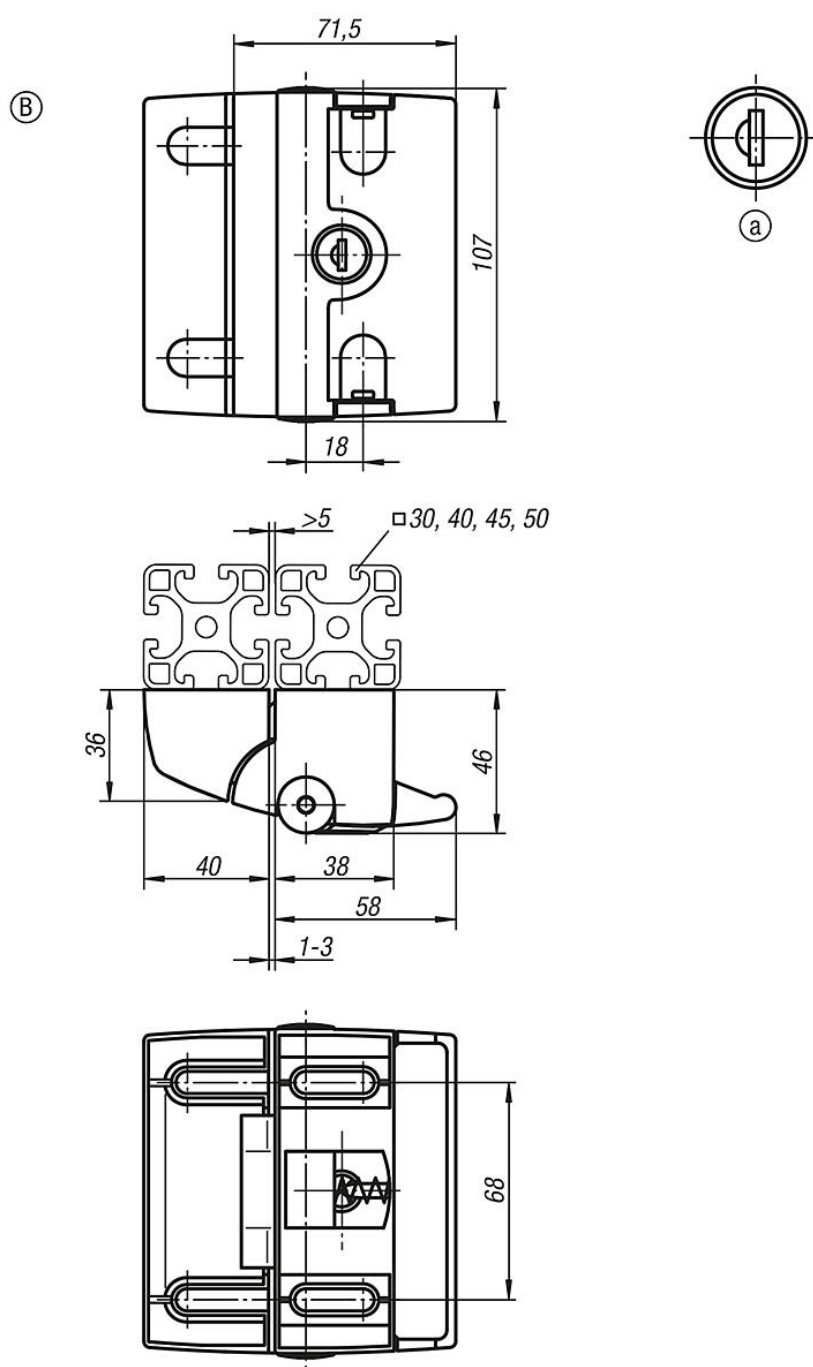

Overview of items

Order No.	Main colour	Form	Slot width	Actuation
05598-200681	black	B	8/10	not lockable
05598-270681	black	B	8/10	key

