

Item description/product images



Description

Material:

Steel or stainless steel A2.

Version:

Grade 12.9. Shaft OD ground and bright.

Bright stainless steel or tempered steel.

Note:

Hexagon socket head shoulder screws are precision construction elements for many applications. As they can simplify complicated constructions, they are frequently chosen as the most cost-effective solution. Shoulder screws provide the decisive rationalising effect required today.

Drawings

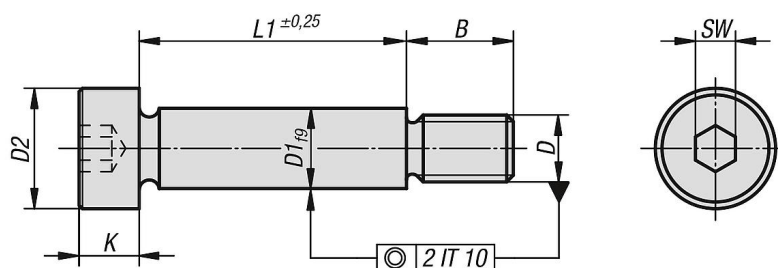

Overview of items

Order No.	Main material	D1	D	D2	B	K	SW	L1
07534-04X04	steel	4	M3	7	7	3	2	4
07534-04X05	steel	4	M3	7	7	3	2	5
07534-04X06	steel	4	M3	7	7	3	2	6
07534-04X08	steel	4	M3	7	7	3	2	8
07534-04X10	steel	4	M3	7	7	3	2	10
07534-04X12	steel	4	M3	7	7	3	2	12
07534-04X16	steel	4	M3	7	7	3	2	16
07534-04X20	steel	4	M3	7	7	3	2	20
07534-04X25	steel	4	M3	7	7	3	2	25
07534-04X30	steel	4	M3	7	7	3	2	30
07534-05X05	steel	5	M4	9	8	4	2,5	5
07534-05X06	steel	5	M4	9	8	4	2,5	6
07534-05X08	steel	5	M4	9	8	4	2,5	8
07534-05X10	steel	5	M4	9	8	4	2,5	10
07534-05X12	steel	5	M4	9	8	4	2,5	12
07534-05X16	steel	5	M4	9	8	4	2,5	16
07534-05X20	steel	5	M4	9	8	4	2,5	20
07534-05X25	steel	5	M4	9	8	4	2,5	25
07534-05X30	steel	5	M4	9	8	4	2,5	30
07534-05X40	steel	5	M4	9	8	4	2,5	40
07534-06X10	steel	6	M5	10	9,5	4,5	3	10
07534-06X12	steel	6	M5	10	9,5	4,5	3	12
07534-06X16	steel	6	M5	10	9,5	4,5	3	16
07534-06X20	steel	6	M5	10	9,5	4,5	3	20
07534-06X25	steel	6	M5	10	9,5	4,5	3	25
07534-06X30	steel	6	M5	10	9,5	4,5	3	30
07534-06X35	steel	6	M5	10	9,5	4,5	3	35
07534-06X40	steel	6	M5	10	9,5	4,5	3	40

Overview of items

Order No.	Main material	D1	D	D2	B	K	SW	L1
07534-06X45	steel	6	M5	10	9,5	4,5	3	45
07534-06X50	steel	6	M5	10	9,5	4,5	3	50
07534-06X55	steel	6	M5	10	9,5	4,5	3	55
07534-06X60	steel	6	M5	10	9,5	4,5	3	60
07534-06X65	steel	6	M5	10	9,5	4,5	3	65
07534-06X70	steel	6	M5	10	9,5	4,5	3	70
07534-06X80	steel	6	M5	10	9,5	4,5	3	80
07534-08X16	steel	8	M6	13	11	5,5	4	16
07534-08X20	steel	8	M6	13	11	5,5	4	20
07534-08X25	steel	8	M6	13	11	5,5	4	25
07534-08X30	steel	8	M6	13	11	5,5	4	30
07534-08X40	steel	8	M6	13	11	5,5	4	40
07534-08X45	steel	8	M6	13	11	5,5	4	45
07534-08X50	steel	8	M6	13	11	5,5	4	50
07534-08X55	steel	8	M6	13	11	5,5	4	55
07534-08X60	steel	8	M6	13	11	5,5	4	60
07534-08X65	steel	8	M6	13	11	5,5	4	65
07534-08X70	steel	8	M6	13	11	5,5	4	70
07534-08X90	steel	8	M6	13	11	5,5	4	90
07534-08X80	steel	8	M6	13	11	5,5	4	80
07534-08X100	steel	8	M6	13	11	5,5	4	100
07534-10X16	steel	10	M8	16	13	7	5	16
07534-10X20	steel	10	M8	16	13	7	5	20
07534-10X25	steel	10	M8	16	13	7	5	25
07534-10X30	steel	10	M8	16	13	7	5	30
07534-10X35	steel	10	M8	16	13	7	5	35
07534-10X40	steel	10	M8	16	13	7	5	40
07534-10X45	steel	10	M8	16	13	7	5	45
07534-10X50	steel	10	M8	16	13	7	5	50
07534-10X55	steel	10	M8	16	13	7	5	55
07534-10X60	steel	10	M8	16	13	7	5	60
07534-10X65	steel	10	M8	16	13	7	5	65
07534-10X70	steel	10	M8	16	13	7	5	70
07534-10X80	steel	10	M8	16	13	7	5	80
07534-10X90	steel	10	M8	16	13	7	5	90
07534-10X100	steel	10	M8	16	13	7	5	100
07534-12X16	steel	12	M10	18	16	9	6	16
07534-12X20	steel	12	M10	18	16	9	6	20
07534-12X25	steel	12	M10	18	16	9	6	25
07534-12X30	steel	12	M10	18	16	9	6	30
07534-12X35	steel	12	M10	18	16	8	6	35
07534-12X40	steel	12	M10	18	16	9	6	40
07534-12X45	steel	12	M10	18	16	8	6	45
07534-12X50	steel	12	M10	18	16	9	6	50
07534-12X55	steel	12	M10	18	16	8	6	55
07534-12X60	steel	12	M10	18	16	9	6	60
07534-12X65	steel	12	M10	18	16	8	6	65
07534-12X70	steel	12	M10	18	16	9	6	70
07534-12X80	steel	12	M10	18	16	9	6	80
07534-12X90	steel	12	M10	18	16	9	6	90
07534-12X100	steel	12	M10	18	16	9	6	100
07534-16X25	steel	16	M12	24	18	11	8	25
07534-16X30	steel	16	M12	24	18	11	8	30
07534-16X35	steel	16	M12	24	18	11	8	35
07534-16X40	steel	16	M12	24	18	11	8	40
07534-16X45	steel	16	M12	24	18	11	8	45
07534-16X50	steel	16	M12	24	18	11	8	50
07534-16X55	steel	16	M12	24	18	11	8	55
07534-16X60	steel	16	M12	24	18	11	8	60
07534-16X65	steel	16	M12	24	18	11	8	65
07534-16X70	steel	16	M12	24	18	11	8	70
07534-16X80	steel	16	M12	24	18	11	8	80
07534-16X90	steel	16	M12	24	18	11	8	90
07534-16X100	steel	16	M12	24	18	11	8	100
07534-16X120	steel	16	M12	24	18	11	8	120

Overview of items

Order No.	Main material	D1	D	D2	B	K	SW	L1
07534-20X30	steel	20	M16	30	22	14	10	30
07534-20X35	steel	20	M16	30	22	14	10	35
07534-20X40	steel	20	M16	30	22	14	10	40
07534-20X45	steel	20	M16	30	22	14	10	45
07534-20X50	steel	20	M16	30	22	14	10	50
07534-20X55	steel	20	M16	30	22	14	10	55
07534-20X60	steel	20	M16	30	22	14	10	60
07534-20X65	steel	20	M16	30	22	14	10	65
07534-20X70	steel	20	M16	30	22	14	10	70
07534-20X80	steel	20	M16	30	22	14	10	80
07534-20X90	steel	20	M16	30	22	14	10	90
07534-20X100	steel	20	M16	30	22	14	10	100
07534-20X120	steel	20	M16	30	22	14	10	120
07534-24X50	steel	24	M20	36	27	16	12	50
07534-24X55	steel	24	M20	36	27	16	12	55
07534-24X60	steel	24	M20	36	27	16	12	60
07534-24X65	steel	24	M20	36	27	16	12	65
07534-24X70	steel	24	M20	36	27	16	12	70
07534-24X80	steel	24	M20	36	27	16	12	80
07534-24X90	steel	24	M20	36	27	16	12	90
07534-24X100	steel	24	M20	36	27	16	12	100
07534-104X04	stainless steel A2	4	M3	7	7	3	2	4
07534-104X06	stainless steel A2	4	M3	7	7	3	2	6
07534-104X05	stainless steel A2	4	M3	7	7	3	2	5
07534-104X08	stainless steel A2	4	M3	7	7	3	2	8
07534-104X10	stainless steel A2	4	M3	7	7	3	2	10
07534-104X12	stainless steel A2	4	M3	7	7	3	2	12
07534-104X16	stainless steel A2	4	M3	7	7	3	2	16
07534-104X20	stainless steel A2	4	M3	7	7	3	2	20
07534-105X05	stainless steel A2	5	M4	9	8	4	2,5	5
07534-105X06	stainless steel A2	5	M4	9	8	4	2,5	6
07534-105X08	stainless steel A2	5	M4	9	8	4	2,5	8
07534-105X10	stainless steel A2	5	M4	9	8	4	2,5	10
07534-105X12	stainless steel A2	5	M4	9	8	4	2,5	12
07534-105X16	stainless steel A2	5	M4	9	8	4	2,5	16
07534-105X20	stainless steel A2	5	M4	9	8	4	2,5	20
07534-105X25	stainless steel A2	5	M4	9	8	4	2,5	25
07534-105X30	stainless steel A2	5	M4	9	8	4	2,5	30
07534-105X40	stainless steel A2	5	M4	9	8	4	2,5	40
07534-106X10	stainless steel A2	6	M5	10	9,5	4,5	3	10
07534-106X12	stainless steel A2	6	M5	10	9,5	4,5	3	12
07534-106X16	stainless steel A2	6	M5	10	9,5	4,5	3	16
07534-106X20	stainless steel A2	6	M5	10	9,5	4,5	3	20
07534-106X25	stainless steel A2	6	M5	10	9,5	4,5	3	25
07534-106X30	stainless steel A2	6	M5	10	9,5	4,5	3	30
07534-106X40	stainless steel A2	6	M5	10	9,5	4,5	3	40
07534-106X50	stainless steel A2	6	M5	10	9,5	4,5	3	50
07534-106X60	stainless steel A2	6	M5	10	9,5	4,5	3	60
07534-108X16	stainless steel A2	8	M6	13	11	5,5	4	16
07534-108X20	stainless steel A2	8	M6	13	11	5,5	4	20
07534-108X25	stainless steel A2	8	M6	13	11	5,5	4	25
07534-108X30	stainless steel A2	8	M6	13	11	5,5	4	30
07534-108X40	stainless steel A2	8	M6	13	11	5,5	4	40
07534-108X50	stainless steel A2	8	M6	13	11	5,5	4	50
07534-108X60	stainless steel A2	8	M6	13	11	5,5	4	60
07534-110X16	stainless steel A2	10	M8	16	13	7	5	16
07534-110X20	stainless steel A2	10	M8	16	13	7	5	20
07534-110X25	stainless steel A2	10	M8	16	13	7	5	25
07534-110X30	stainless steel A2	10	M8	16	13	7	5	30
07534-110X40	stainless steel A2	10	M8	16	13	7	5	40
07534-110X50	stainless steel A2	10	M8	16	13	7	5	50
07534-110X60	stainless steel A2	10	M8	16	13	7	5	60
07534-110X70	stainless steel A2	10	M8	16	13	7	5	70
07534-110X80	stainless steel A2	10	M8	16	13	7	5	80
07534-110X90	stainless steel A2	10	M8	16	13	7	5	90

Overview of items

Order No.	Main material	D1	D	D2	B	K	SW	L1
07534-110X100	stainless steel A2	10	M8	16	13	7	5	100
07534-112X16	stainless steel A2	12	M10	18	16	9	6	16
07534-112X20	stainless steel A2	12	M10	18	16	9	6	20
07534-112X25	stainless steel A2	12	M10	18	16	9	6	25
07534-112X30	stainless steel A2	12	M10	18	16	9	6	30
07534-112X40	stainless steel A2	12	M10	18	16	9	6	40
07534-112X50	stainless steel A2	12	M10	18	16	9	6	50
07534-112X60	stainless steel A2	12	M10	18	16	9	6	60
07534-112X70	stainless steel A2	12	M10	18	16	9	6	70
07534-112X80	stainless steel A2	12	M10	18	16	9	6	80
07534-112X90	stainless steel A2	12	M10	18	16	9	6	90
07534-112X100	stainless steel A2	12	M10	18	16	9	6	100
07534-116X30	stainless steel A2	16	M12	24	18	11	8	30
07534-116X40	stainless steel A2	16	M12	24	18	11	8	40
07534-116X50	stainless steel A2	16	M12	24	18	11	8	50
07534-116X60	stainless steel A2	16	M12	24	18	11	8	60
07534-116X70	stainless steel A2	16	M12	24	18	11	8	70
07534-116X80	stainless steel A2	16	M12	24	18	11	8	80
07534-116X90	stainless steel A2	16	M12	24	18	11	8	90
07534-116X100	stainless steel A2	16	M12	24	18	11	8	100
07534-116X120	stainless steel A2	16	M12	24	18	11	8	120
07534-120X30	stainless steel A2	20	M16	30	22	14	10	30
07534-120X40	stainless steel A2	20	M16	30	22	14	10	40
07534-120X50	stainless steel A2	20	M16	30	22	14	10	50
07534-120X60	stainless steel A2	20	M16	30	22	14	10	60
07534-120X70	stainless steel A2	20	M16	30	22	14	10	70
07534-120X80	stainless steel A2	20	M16	30	22	14	10	80
07534-120X90	stainless steel A2	20	M16	30	22	14	10	90
07534-120X100	stainless steel A2	20	M16	30	22	14	10	100
07534-120X120	stainless steel A2	20	M16	30	22	14	10	120