

Description de l'article/illustrations du produit



Description

Matière :
Acier de traitement.

Finition :
Traité et bruni.

Nota :
Les ensembles de bridage pivotants sont utilisés afin de laisser le champ libre pour placer ou enlever la pièce à usiner.

* Force manuelle admissible pour la poignée.

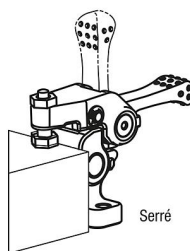
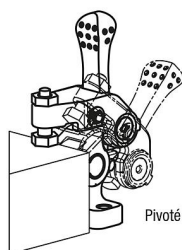
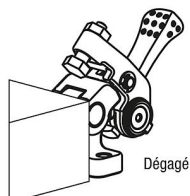

Dessins

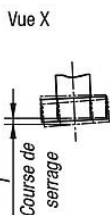
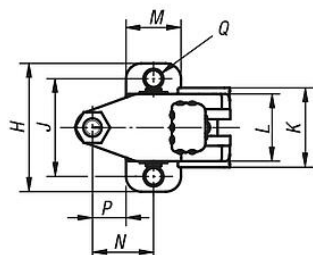
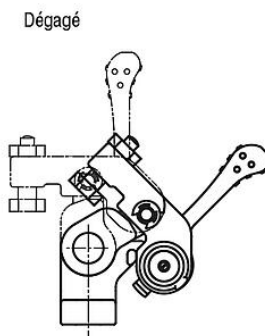
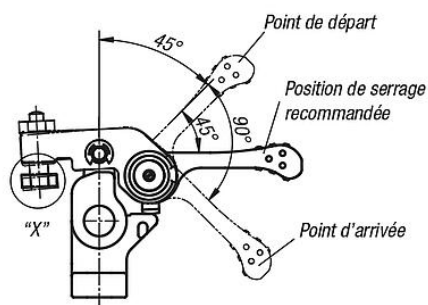
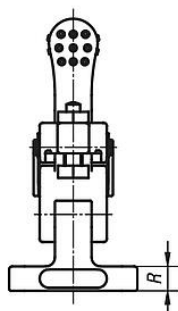
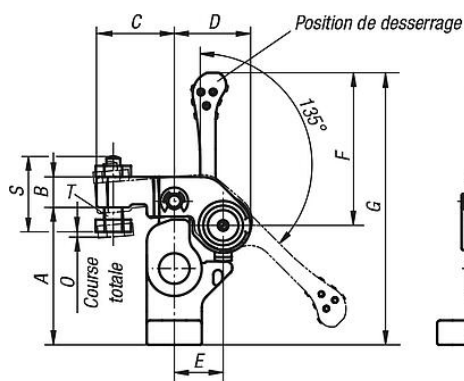

Serrage de surfaces brutes

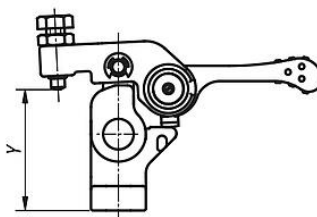

Serrage de surfaces usinées

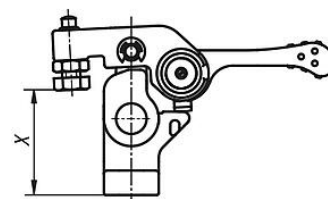

Aperçu des articles

Référence	A	B	C	D	E	F	G	H	I	J	K	L	M	N	O	P	Q	R	S	T	X min.	X max.	Y min.	Y max.	F=Force de serrage N	Force FH N
04610-100	45	10	25,5	25	16	50	89	42	1	32	26	22	18	20	1,5	11	5,5	8	24	M6	31,5	40,5	34,5	43,5	700	100*
04610-150	55	12	32	31	20	63	109	52	1,2	40	32	28	22	25	1,8	14	6,6	10	30,5	M8	36,4	48,6	41,4	53,6	1100	150*